

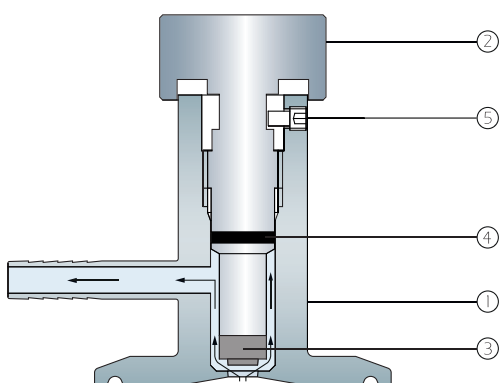

Designed for sampling water and process fluids, the HSV30 utilises a TFM-PTFE or PEEK seat seal to ensure bubble tight shut-off. The HSV30 is available with a range of ASME BPE, DIN and ISO clamp system connections and 6.5mm hose barb sample outlet fitting. The sample outlet is fitted with a removable silicone dust cap. The HSV30 is suitable for applications where flushing or sterilisation of the sample chamber is to be performed.



- P Pressure Rating**
Up to 10 barg
- T Temperature Rating**
Up to 150°C
- Connections**
Inlet - 1/2" - 2" ASME BPE clamp
DN8 - DN50 ISO and DIN clamp
Outlet - 2.5mm x 4.2mm clamp or 6.5mm hose barb
- Orifice Diameter**
5.0mm
- Seal Material**
Seat seal - TFM-PTFE or PEEK
Stem seal - EPDM, Viton or Silicone
- Surface Finish**
Wetted surfaces - 0.38 microns Ra and electropolished
External surfaces - 0.8 microns Ra and electropolished
- Options**
Flushing port
- Available Certification**
 - CofC** Certificate of Conformity
 - MTR's** Material Certification
 - FDA** FDA Elastomer compliance certificates
 - USP** USP Elastomer compliance certificates
 - ADI** Certified 'Animal Derived Ingredient' free

Part	Description
1	Body 316L stainless steel
2	Valve stem 316L stainless steel
3	Seat seal TFM-PTFE or PEEK
4	Stem seal EPDM, Viton or Silicone
5	Travel stop Stainless steel
-	Dust cap Silicone

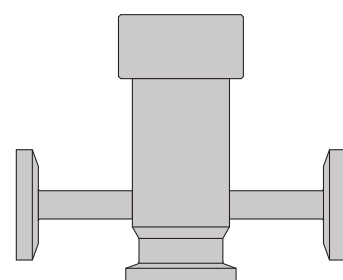

HSV30 with flushing port

HSV30												
ASME BPE	System connection					Outlet	Dimensions (mm)					Weight (kg)
	1/2"	3/4"	1"	1-1/2"	2"		ØA	B	C	D	E	
ISO	DN8 & DN10	DN15*	DN20	DN25 & DN32	DN40	6.5mm barb 25mm clamp**						
DIN	DN8 & DN10*	DN15*	DN20* & DN25	DN32 & DN40	DN50		25mm clamp**					
	✓	✓				✓	25	6.5	64	18	40	0.2
			✓	✓		✓	50.5	6.5	64	18	40	0.25
					✓	✓	64	6.5	64	18	40	0.3
	✓	✓				✓	25	25	64	18	42	0.2
			✓			✓	50.5	25	64	18	42	0.2
	✓	✓				✓	25	25	64	18	42	0.25
			✓			✓	50.5	25	64	18	50	0.25

*ISO DN 15, DIN DN8 - DN20 available with 25mm or 34mm clamp connection. ISO DN 15 available with 50.5mm clamp connection

**Outlet fitting is 25mm clamp to suit ASME BPE, DIN and ISO fittings with 4.2mm bore

Packaging
Individually capped, bagged and boxed

Service Parts
Seal kit comprising parts 3 and 4