

PIPE ADAPTOR FERRULES



PIPE ADAPTORS

Pipe adaptor ferrules allow standard clamped components to be used in schedule piping systems. An internal machined taper ensures a smooth transition between the pipe and clamp fitting bores. Pipe adaptor ferrules are manufactured from 316L stainless steel with all surfaces finished to 0.8 microns Ra.

- I Connections** Clamp end to suit 1/2" - 2" ASME BPE fittings
Weld end to suit 1/2" - 2" Sch 10 or Sch 40 pipe
- M Material** 316L stainless steel
- S Surface Finish** All surfaces - 0.8 microns Ra
- O Options** Alternative pipe vs. tube combinations
Electropolished finish
- C Certification** Certificate of conformity
Material certification
Certified 'Animal derived ingredient' free

Pipe Adaptor Ferrules

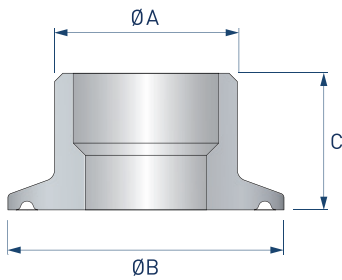

	Pipe size		Clamp size		Length C (mm)
	(ASTM A312)	ØA (mm)	(ASME BPE)	ØB (mm)	
	1/2"	21.3	1/2"	25	25
	1/2"	21.3	3/4"	25	25
	3/4"	26.7	1/2"	25	25
	3/4"	26.7	3/4"	25	25
	3/4"	26.7	1"	50.5	25
	1"	33.4	3/4"	25	25
	1"	33.4	1"	50.5	25
	1"	33.4	1-1/2"	50.5	25
	1-1/4"	42.2	1"	50.5	25
	1-1/4"	42.2	1-1/2"	50.5	28
	1-1/2"	48.3	1"	50.5	28
	1-1/2"	48.3	1-1/2"	50.5	28
	2"	60.3	2"	64	28

Pipe Adaptor Ferrules - ordering code

Pipe size (ASTM A312)	Clamp size (ASME BPE)	Schedule 10 pipe	Schedule 40 pipe
1/2"	1/2"	PFER-050S10-050C	PFER-050S40-050C
1/2"	3/4"	PFER-050S10-075C	PFER-050S40-075C
3/4"	1/2"	PFER-075S10-050C	PFER-075S40-050C
3/4"	3/4"	PFER-075S10-075C	PFER-075S40-075C
3/4"	1"	PFER-075S10-100C	PFER-075S40-100C
1"	3/4"	PFER-100S10-075C	PFER-100S40-075C
1"	1"	PFER-100S10-100C	PFER-100S40-100C
1"	1-1/2"	PFER-100S10-150C	PFER-100S40-150C
1-1/4"	1"	PFER-125S10-100C	PFER-125S40-100C
1-1/4"	1-1/2"	PFER-125S10-150C	PFER-125S40-150C
1-1/2"	1"	PFER-150S10-100C	PFER-150S40-100C
1-1/2"	1-1/2"	PFER-150S10-150C	PFER-150S40-150C
2"	2"	PFER-200S10-200C	PFER-200S40-200C

Specification text

Staitech pipe adaptor ferrule manufactured from 316L stainless steel. 1/2" ASTM A312 Schedule 10 pipe weld end and 1/2" ASME BPE clamp connection. All surfaces finished to 0.8 microns Ra. (PFER-050S10-050C). For electropolished finish add suffix '-EP' (PFER-050S10-050C-EP).