

PIPE-TO-TUBE ADAPTORS



PIPE-TO-TUBE ADAPTORS

Pipe-to-tube butt weld adaptors allow standard tubing components to be used in piping systems with a machined taper ensuring a smooth transition between the pipe and tube bores. Adaptors are manufactured from low sulphur 316L stainless steel complying with ASME BPE criteria with wetted surfaces finished to 0.5 microns Ra. To facilitate orbital welding fittings have a 25mm long weld shoulder.

- Connections** End 1 to suit 1/2" - 2" ASME BPE tube
End 2 to suit 1/2" - 2" Schedule pipe
- Material** 316L stainless steel (ASME BPE compliant)
- Surface Finish** All surfaces - 0.5 microns Ra (SF1)
- Options** 2-1/2", 3" and 4" sizes in 316L and ASME BPE compliant 316L material
Alternative pipe vs. tube combinations
ISO and DIN pipe and tube dimensions
Electropolished finish (SF4)
- Certification** Certificate of conformity
Material certification
Certified 'Animal derived ingredient' free

Pipe-to-Tube Adaptors

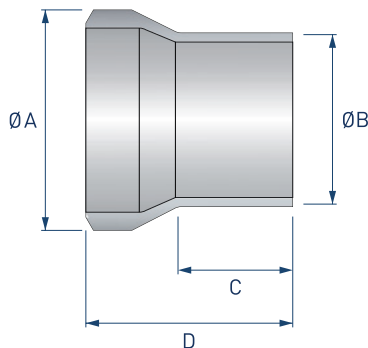

Pipe size (ASTM A312) ØA (mm)		Tube size (ASME BPE) ØB (mm)		Length C (mm)	Length D (mm)
3/8"	17.2	3/8"	9.5	25	30
3/8"	17.2	1/2"	12.7	25	34
3/8"	17.2	3/4"	19.05	25	33
1/2"	21.3	1/4"	6.35	15*	36
1/2"	21.3	3/8"	9.5	25	43
1/2"	21.3	1/2"	12.7	25	40
1/2"	21.3	3/4"	19.05	25	36
3/4"	26.7	1/2"	12.7	25	45
3/4"	26.7	3/4"	19.05	25	40
3/4"	26.7	1"	25.4	25	35
1"	33.4	1/2"	12.7	25	53
1"	33.4	3/4"	19.05	25	48
1"	33.4	1"	25.4	25	42
1-1/4"	42.2	1-1/2"	38.1	25	39
1-1/2"	48.3	1"	25.4	25	55
1-1/2"	48.3	1-1/2"	38.1	25	45
2"	60.3	1"	25.4	25	66
2"	60.3	1-1/2"	38.1	25	55
2"	60.3	2"	50.8	25	45

*Longer weld tangent available to order

Pipe-to-Tube Adaptors - ordering code			
Pipe size (ASTM A312)	Clamp size (ASME BPE)	Schedule 10 pipe	Schedule 40 pipe
3/8"	3/8"	CRED-0375S10-0375W	CRED-0375S40-0375W
3/8"	1/2"	CRED-0375S10-050W	CRED-0375S40-050W
3/8"	3/4"	CRED-0375S10-075W	CRED-0375S40-075W
1/2"	1/4"	CRED-050S10-0125W	CRED-050S40-0125W
1/2"	3/8"	CRED-050S10-0375W	CRED-050S40-0375W
1/2"	1/2"	CRED-050S10-050W	CRED-050S40-050W
1/2"	3/4"	CRED-050S10-075W	CRED-050S40-075W
3/4"	1/2"	CRED-075S10-050W	CRED-075S40-050W
3/4"	3/4"	CRED-075S10-075W	CRED-075S40-075W
3/4"	1"	CRED-075S10-100W	CRED-075S40-100W
1"	1/2"	CRED-100S10-050W	CRED-100S40-050W
1"	3/4"	CRED-100S10-075W	CRED-100S40-075W
1"	1"	CRED-100S10-100W	CRED-100S40-100W
1-1/4"	1-1/2"	CRED-125S10-150W	CRED-125S40-150W
1-1/2"	1"	CRED-150S10-100W	CRED-150S40-100W
1-1/2"	1-1/2"	CRED-150S10-150W	CRED-150S40-150W
2"	1"	CRED-200S10-100W	CRED-200S40-100W
2"	1-1/2"	CRED-200S10-150W	CRED-200S40-150W
2"	2"	CRED-200S10-200W	CRED-200S40-200W

Specification text

Staitech pipe-to-tube adaptor manufactured from 316L stainless steel. 3/8" ASTM A312 Schedule 10 pipe x 3/8" ASME BPE weld connections. All surfaces finished to 0.5 microns Ra. (CRED-0375S10-0375W). For electropolished finish add suffix '-EP' (CRED-0375S10-0375W-EP).